



2 FARAN ST. NORTH INDUSTRIAL ZONE
P.O.B. 676 YAVNE 81106 ISRAEL
TEL:972-8-9435056, FAX:972-8-9431921

RE: BASIC SAFE SPECIFICATION – MODEL 802 D

J.SH Model Supreme series - 801 D .

Outside Dimensions: H-230mm W-420mm D-250mm

- 28.3L
- Left / Right door opening
- Suitable to insert personal laptop computer.
- Made in Israel in the highest quality standard

Main features as standard :

Audit trial report :

- Complete print audit trial, including print-up of up to **400 last** Events including :
- Time & date for each event (open / closed) "14 .7.09 10:15".
 - Incorrect guest codes – HOLD 15 .
 - Identification of service operator with full name – " Robert Johnson".
 - Print audit of service unit of all security users for each event with time and date .
 - Date and time of service unit open safe (ID user or override system).
 - Full management control on the service unit .

Safe Features :

- * Simple intuitive operation by 4-6 personal digital code.
- * Six digital bright red led display.
- * ADA approved unique epoxy rubber keypad.
- * Automatic inside light.
- * Raised illuminated key buttons .
- * Twin locking bolts from chrome plated solid steel.
- * Self-Diagnostic trouble-shooting on display.
- * Safety lockout feature – safe display 'closed' only in case locking bolts are closed 100%.
- * Various customizable programming functions.
- * 15 minutes shut-down following 4 fault opening attempts.
- * Locking prevention on LOW-BATTERIES.
- * Colors available : ivory , black , combination grey .

**Supreme 801 D Laptop - Outside Dimensions: H-230mm W-420mm D-250mm
Automatic inside light + illuminated key buttons**



802

**TWO SOLID STEEL BOLTS
LOCKING SYSTEM**

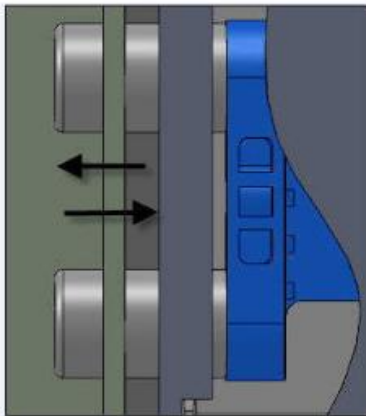

**ANTI-TAMPER LABYRINTHS
FOR FLAT CABLE**

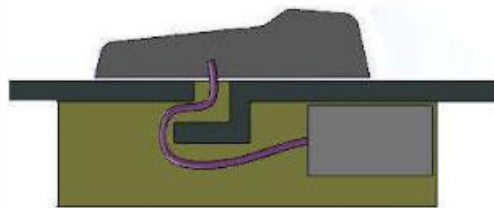

**SOLID STEEL
BOLT HINGE**

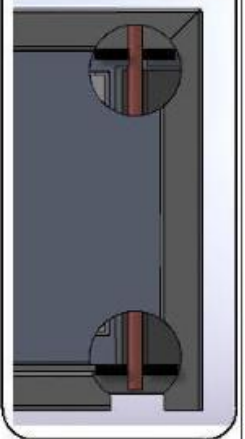

SAFE LOGGER UNIT - service unit

The state-of-the-art Safe Logger Unit (SLU) has been designed to open the safe in case of emergency and also to perform security management tasks.

The SLU is a very easy unit to use and it has an interactive LCD light display with full operation instructions. If there is any suspicion of theft from a safe, the unit can detect and download the last 400 events from the safe, which includes the Hotel name, room number, employee's name and ID, date & time of each event and the date of the print out. This dramatically reduces fraudulent liability claims, saving you both time and money. All downloaded data can be viewed on the SLU screen at all times, and the SLU can be connected directly to a standard or POS printer to obtain a hard copy of the data.



TM

The SLU can be programmed to work on a specific property, thus allowing each hotel to set their own Override codes, in order to open safes in emergency cases. The SLU allows 4 programming security levels in order to control the programming of the users. Different authorized users can then operate the SLU by setting their own codes.

The SLU unit includes a "self" audit memory up to the last 500 events on the SLU itself, including the user ID, time & date, room number and the type of events the user operated with the unit (like open safe, download data, changing programming etc.). This reports is immune to power failure or attempts at deletion.